

Описание мет на насос серии GC



## Series Overview

## Series GC

Order Code		Gear Set		Drive Mount		Options		Pump Construction	
Base Code								Magnetic Drive Gear Pump Suction Shoe Style Two or Three Helical Gears/DP20 Stationary Shafts O-Ring Seal (Qty 1)	
1	2	3	4	5	6	7	8		
G	C	M35	J	V	S	6			
Model		Wetted Materials				O/C: Pump S/K: Service Kit			

Base Code	Select a code character for each numbered position to configure the product.			Specifications	Notes
1	Code	Product Type			
G		Gear Pump			
2	Product Series	Max System Pressure (MAWP)	Ports		
C		Series GC	See Drive Mount	3/8-18 (F) NPT Side Ports	
3	Modifier				
-		Standard Design			
4	Gear Set (Width/N°Gears/Pitch)	Displacement	Max Differential Pressure	Driven Magnet (Standard)	
M23	0.350/2/20	0.81 ml/rev (0.21 gal/1000*rev)	8.7 Bar (125 psi)	Ferrite	
M25	0.750/2/20	1.82 ml/rev (0.48 gal/1000*rev)	8.7 Bar (125 psi)	Ferrite	
M25	0.750/3/20	3.48 ml/rev (0.92 gal/1000*rev)	5.2 Bar (75 psi)	Ferrite	
5	Gear Material	Max Differential Pressure	Temp Range		
P	PPS (carbon fiber/ptfe)	5.2 Bar (75 psi)	-46/177°C (-50/350°F)		
J	PEEK (carbon fiber/ptfe)	8.7 Bar (125 psi)	-46/177°C (-50/350°F)		
6	Static Seals		Temp Range		
D	EP		-46/149°C (-50/300°F)		
V	Viton®		-29/204°C (-20/400°F)		
F5	TEV (PTFE encap Viton®)		-29/204°C (-20/400°F)		
K	Kalrez®		-29/260°C (-20/500°F)		
7	Base Materials				
S	SS316				
D	Alloy 20				
T	Titanium				
C	Hast C-276®				
8	Drive Mount	Max System Pressure (MAWP)	Weight (Pumphead)		
E	NEMA 56C	103 Bar (1500 psi)	2.7 kg (6.0 lbs)		
6	IEC 71-B14	103 Bar (1500 psi)	2.7 kg (6.0 lbs)		
Options					
Add Option codes after the Base Code to modify features or enhance the product.					
Driving Magnet (PC13)					
NB NdFeB Driving (Ring)					
Notes					

Универсальный насос

1/Норматив п.с/ 26.06.2018

PRICES ARE FOB/EX-WORKS FACTORY - Prices shown are the Manufacturer's Suggested List Price and are subject to change without notice.

USA: Micropump, Inc., A Unit of IDEX Corporation • Phone 360.253.2008 • Fax 360.253.2401

UK: Micropump, Ltd., A Subsidiary of Micropump, Inc. • Phone +44 (1480) 356900 • Fax +44 (1480) 356920

info.micropump@idexcorp.com

www.micropump.com

Page 1 of 1  
Form F312 Rev B

© 1999-2005 Micropump, Inc. Trademarks belong to their respective owners.

GC000S.2MPV  
Effective: 01-Sep-05



## Technical Data

## Series GC

Order Code				Gear Set				Drive Mount				Options		<b>Pump Construction</b> Magnetic Drive Gear Pump Suction Shoe Style Two or Three Helical Gears/DP20 Stationary Shafts O-Ring Seal (Qty 1)
Base Code														
G	C	-	M35	J	V	S	6							
1	2	3	4	5	6	7	8							
Model				Wetted Materials						O/C: Pump S/K: Service Kit				



## Performance

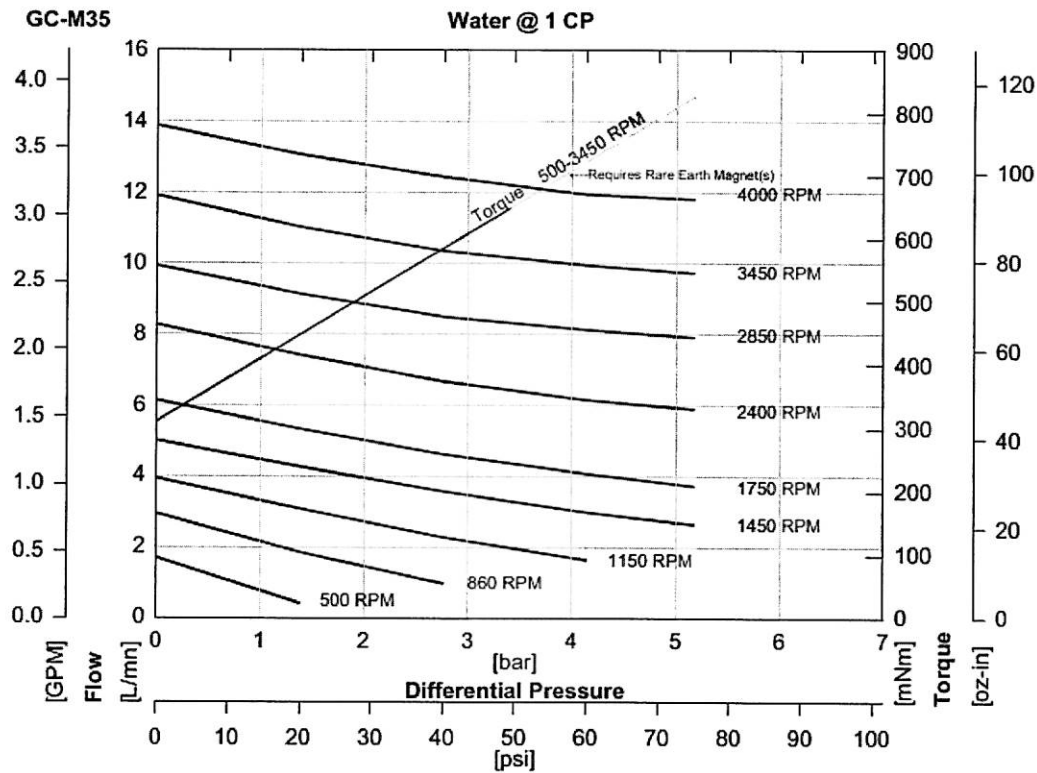

ACTUAL PERFORMANCE MAY VARY • Specifications are subject to change without notice. When multiple specs are noted, the most conservative value applies.

USA: Micropump, Inc., A Unit of IDEX Corporation • Phone 360.253.2008 • Fax 360.253.2401  
 UK: Micropump, Ltd., A Subsidiary of Micropump, Inc. • Phone +44 (1480) 356900 • Fax +44 (1480) 356920  
 info@micropump.com www.micropump.com

Form F323 Rev A

© 2000-2005 Micropump, Inc., Trademarks belong to their respective ow

GC700 Rev A  
 Page 1  
 Printed 06-Oct-05



## Technical Data

## Series GC



## Technical Data

## Series GC

<b>Order Code</b>								<b>Pump Construction</b>	
<b>Base Code</b>		<b>Gear Set</b>		<b>Drive Mount</b>		<b>Options</b>		 Magnetic Drive Gear Pump Suction Shoe Style Two or Three Helical Gears/DP20 Stationary Shafts O-Ring Seal (Qty 1)	
<b>G</b>	<b>C</b>	<b>M35</b>	<b>3</b>	<b>4</b>	<b>5</b>	<b>6</b>	<b>7</b>		
1	2	3	4	5	6	7	8		
Model		Wetted Materials		O/C: Pump		S/K: Service Kit			

Specifications

	SI	US
Displacement	3.48 ml/rev	0.92 gal/1000*rev
Max Flow (4 Pole Speed)	5.1 L/mn 1450 RPM (50Hz)	1.7 gal/mn 1750 RPM (60Hz)
Max Flow (2 Pole Speed)	10.0 L/mn 2850 RPM (50Hz)	3.2 gal/mn 3450 RPM (60Hz)
Max Differential Pressure	1 5.2 Bar	75 psi
Max System Pressure (MAWP)	See Drive Mount	See Drive Mount
NIPR (Absolute)	180 mBar	2.5 psia
Wet Lift (Typical)	2 51 cm.H2O (1450 RPM)	24 in.H2O (1750 RPM)
Temp Range	3 See Gear Material	See Gear Material
Viscosity Range	4 0.2 to 1500 cp	0.2 to 1500 cp
Max Speed	4,000 RPM	4,000 RPM
Rotation (Facing Motor Shaft)	CW	CW
Weight (Pumphead)	1.7 kg	3.7 lbs
Dimensions (LxWxH)	See Drawing	See Drawing
Ports	3/8-18 (F) NPT Side Ports	3/8-18 (F) NPT Side Ports
Driven Magnet (Standard)	Ferrite	Ferrite
Optional Internal Bypass	No	No

## Notes

- 1 See Product Options. Max pressure depends on gear material.
- 2 Priming ability varies with operating conditions.
- 3 See Product Options for specific temp limits.
- 4 See Performance-High Viscosity for viscosity limits.

ACTUAL PERFORMANCE MAY VARY - Specifications are subject to change without notice. When multiple specs are noted, the most conservative value applies.

USA: Micropump, Inc., A Unit of IDEX Corporation • Phone 360.253.2008 • Fax 360.253.2401  
 UK: Micropump, Ltd., A Subsidiary of Micropump, Inc. • Phone +44 (1480) 356900 • Fax +44 (1480) 356920  
 info@micropump.com www.micropump.com

Form F323 Rev A

© 2006-2005 Micropump, Inc., Trademarks belong to their respective ow

GC700 Rev A  
Page 3  
Printed 06-Oct-05



## Technical Data

## Series GC

<b>Order Code</b>				<b>Gear Set</b>				<b>Drive Mount</b>				<b>Options</b>				<b>Pump Construction</b> Magnetic Drive Gear Pump Cavity Style Three Helical Gears/DP20 Stationary Shafts O-Ring Seal (Qty 1)
<b>Base Code</b>																
G	C	-	M35					4/6								
1	2	3	4	5	6	7	8									
Model				Wetted Materials								O/C: Pump S/K: Service Kit				



## Dimensions

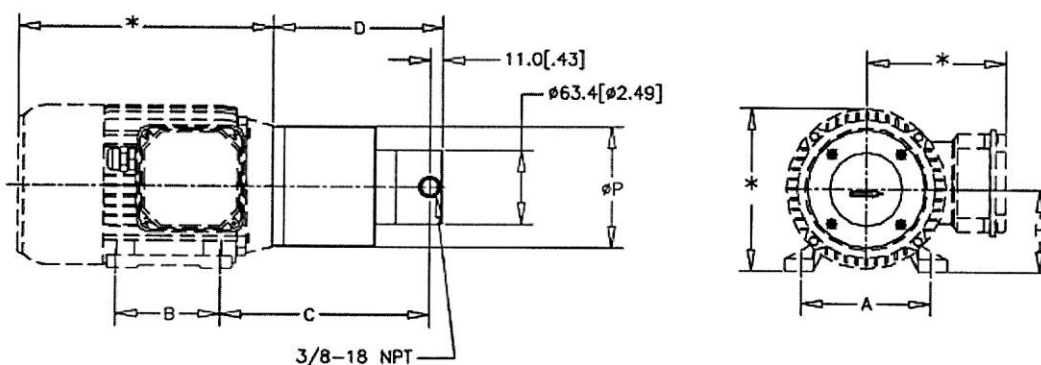

PUMP	MOUNT	A mm [in]	B mm [in]	C mm [in]	D mm [in]	H mm [in]	P mm [in]
GC-M25/M35	IEC71B14B3	100 [3.94]	80 [3.15]	168.9 [6.65]	139.9 [5.51]	63 [2.48]	90 [3.54]
	IEC71B14B3	112 [4.41]	90 [3.54]	180.9 [7.12]	139.9 [5.51]	71 [2.80]	105 [4.13]

## NOTES:

- \*THESE DIMENSIONS WILL VARY BASED ON MOTOR SELECTION.
- ALL DIMENSIONS ARE NOMINAL.

ACTUAL PERFORMANCE MAY VARY • Specifications are subject to change without notice. When multiple specs are noted, the most conservative value applies.

USA: Micropump, Inc., A Unit of IDEX Corporation • Phone 360.253.2008 • Fax 360.253.2401  
 UK: Micropump, Ltd., A Subsidiary of Micropump, Inc. • Phone +44 (1480) 356900 • Fax +44 (1480) 356920  
 info@micropump.com www.micropump.com

Form F323 Rev A

© 2000-2005 Micropump, Inc., Trademarks belong to their respective ow

GD104 Rev A  
 Dimensions 1  
 Printed 06-Oct-05